

STRAIGHT PLUG CRIMP TYPE

R161.092.000

CABLE 8.07/50

Series : N

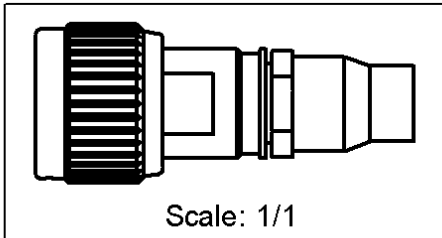
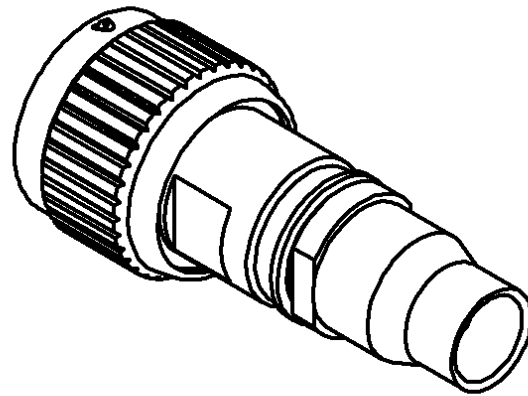
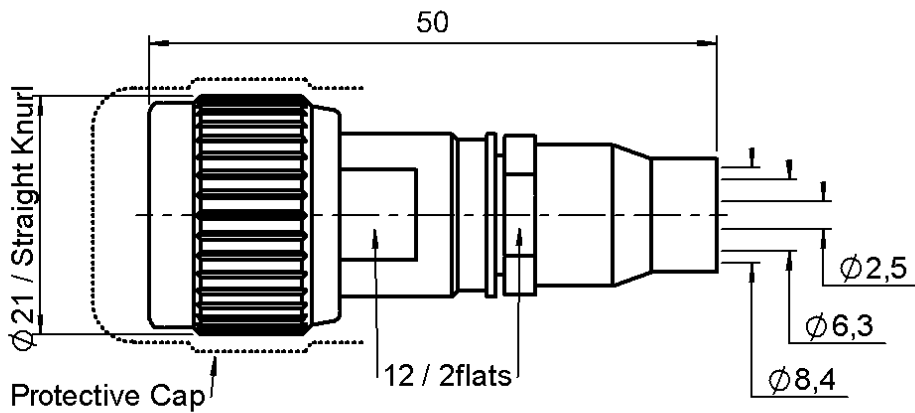

All dimensions are in mm.



| COMPONENTS | MATERIALS | PLATINGS (µm) |
|----------------|-----------------|------------------------|
| BODY | BRASS | NICKEL 2 |
| CENTER CONTACT | BRASS | GOLD 1.3 OVER NICKEL 2 |
| OUTER CONTACT | BRASS | NICKEL 2 |
| INSULATOR | PTFE | |
| GASKET | SILICONE RUBBER | |
| OTHERS PARTS | BRASS | NICKEL 2 |
| - | - | - |
| - | - | - |

Issue : 0708 K

In the effort to improve our products, we reserve the right to make changes judged to be necessary.



STRAIGHT PLUG CRIMP TYPE

R161.092.000

CABLE 8.07/50

Series : N

PACKAGING

| Standard | Unit | Other |
|-----------|-------------------|-------------------|
| 50 | 'W' option | Contact us |

SPECIFICATION

ASNE0462-K -0693 1 00

CABLE ASSEMBLY

| Stripping | a | b | c | d | e | f |
|-----------|------|------|------|------|------|------|
| mm | 9,00 | 8,00 | 26,0 | 0,00 | 0,00 | 0,00 |

ELECTRICAL CHARACTERISTICS

| | | |
|---------------------------------|----------------------|--------------------------|
| Impedance | 50 | Ω |
| Frequency | 0-3 | GHz |
| VSWR | 1.20 + 0,0000 | x F(GHz) Maxi |
| Insertion loss | 0.048 | \sqrt{F} (GHz) dB Maxi |
| RF leakage | - (101) | - F(GHz)) dB mini |
| Voltage rating | 850 | Veff Maxi |
| Dielectric withstanding voltage | 1500 | Veff mini |
| Insulation resistance | 5000 | M Ω mini |

Assembly instruction :

Recommended cable(s)
50 MFCFB FTX

Cable retention

- pull off **400** N mini
- torque **NA** N.cm

MECHANICAL CHARACTERISTICS

| | | |
|----------------------------|-----------|-----------|
| Center contact retention | | |
| Axial force – Mating end | 27 | N mini |
| Axial force – Opposite end | 27 | N mini |
| Torque | NA | N.cm mini |

| | | |
|--------------------|----------------|------|
| Recommended torque | | |
| Mating | 130 | N.cm |
| Panel nut | NA | N.cm |
| Clamp nut | 370 | N.cm |
| A/F clamp nut | 12,0000 | mm |

| | | |
|-------------|----------------|-------------|
| Mating life | 500 | Cycles mini |
| Weight | 41,8000 | g |

TOOLING

| Part Number | Description | Hexagon |
|--------------|------------------------------|--------------|
| . | . | . |
| 282.291 | CRIMPING TOOL M22520/1-01 | 2x4 (pos. 8) |
| 282.997 | LOCATOR | red |
| . | . | . |
| . And - (et) | | |
| R282.293.000 | CRIMPING TOOL M22520/5-01 | - |
| 282.247 | CRIMPING DIE M 22520/5-61 | 10.9 |

OTHERS CHARACTERISTICS

ENVIRONMENTAL

| | | |
|-----------------------|-----------------|--------------|
| Operating temperature | -55/+155 | $^{\circ}$ C |
| Hermetic seal | NA | Atm.cm3/s |
| Panel leakage | NA | |

Issue : 0708 K

In the effort to improve our products, we reserve the right to make changes judged to be necessary.



STRAIGHT PLUG CRIMP TYPE

R161.092.000

CABLE 8.07/50

Series : N

COMPONENTS

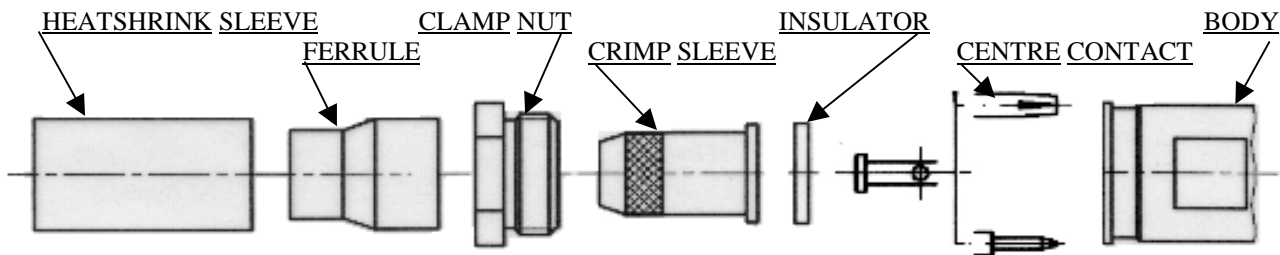

1

Slide onto the cable the heatshrink and the ferrule.
Strip the cable.

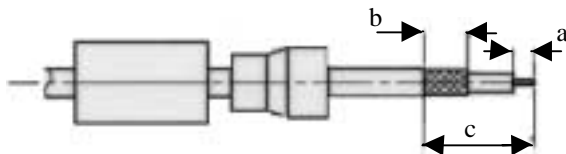

2

Slide the clamp nut onto the crimp sleeve.
Slide sub-assembly under the braid.
Slide ferrule over the braid against clamp nut. (In direction F)
Crimp the ferrule with crimping tool + dies

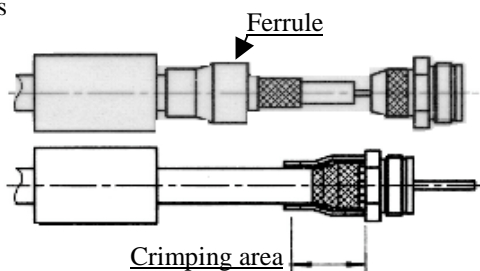

3

Cut the dielectric flush to crimp sleeve.
Mount insulator against crimp sleeve.

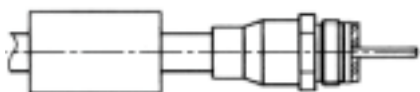

4

Slide the centre contact onto the cable inner conductor against insulator.
Crimp centre contact with the crimping tool and the positioner.

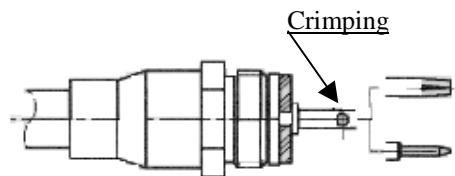

Heatshrink sleeve not shown

5

Screw sub-assembly into the connector body.
(recommended coupling see the connector TDS)
Slide sleeve over ferrule and heatshrink sleeve in the place.

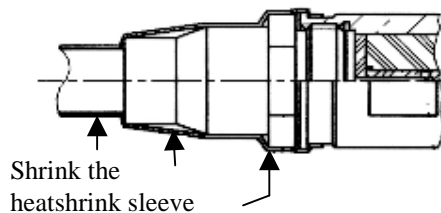

Issue : 0708 K

In the effort to improve our products, we reserve the right to make changes judged to be necessary.

